



Towing and Suspension Solutions

253649-01 02-08

ROADMASTER, Inc. 6110 NE 127th Ave. Vancouver, WA 98682 800-669-9690 Fax 360-735-9300 www.roadmasterinc.com

Even Brake replacement motorhome monitor, ICX transmitter or second vehicle kit

part numbers 9410, 9420 and 9430

Programming Instructions

All specifications are subject to change without notice.

The Even Brake motorhome monitor and the ICX transmitter must be programmed as a set. If a replacement monitor, a replacement ICX transmitter or a second vehicle kit is to be installed, follow the instructions below.

Program the motorhome monitor

Until both the motorhome monitor and the ICX transmitter are programmed as a set, the motorhome monitor will not receive the signal from the ICX transmitter. Follow the instructions below to program the monitor.

A second 12-volt outlet (in addition to the towed vehicle's) will be necessary.

1. Before programming, first install Even Brake in the towed vehicle – follow the installation instructions. Even Brake must be completely installed, with both the ICX transmitter cord and the power cord plugged in.



WARNING

Read the installation instructions and the owner's manual before installing or operating Even Brake. Failure to understand how to install or operate Even Brake could result in property damage, personal injury or even death.

Note: Before transferring Even Brake to a second (or third, or fourth) vehicle, it may be necessary to adjust the feet to maintain stability. Refer to the section titled "Adjust the feet and the seat pad" in the Even Brake owner's manual.

2. Next, plug the motorhome monitor power cord into the second 12-volt outlet. (This outlet must be receiving power for the monitor to operate.) The LCD text display will read "Even Brake."

3. Now, press the "Dim" button on the motorhome monitor (Figure 1) for approximately six seconds, until the LCD text display reads "Receiver is in Learn Mode."

4. Release the "Dim" button. The LCD text display will read "Learning ICX #1 – Advance? OK ↓."

If you are installing a replacement motorhome monitor or a replacement ICX transmitter into the towed vehicle, press the button with the right-hand arrow (>) on the motorhome monitor. The LCD text display will read "Press Even Brake Test Button."

(If you are programming the monitor for a second towed vehicle, press the button with the left-hand arrow (<) on the monitor to scroll to the next message – "Learning ICX #2 – Advance? OK ↓." If you are programming the monitor for a third or fourth towed vehicle, continue to press the button with the left-hand ar-

Figure 1

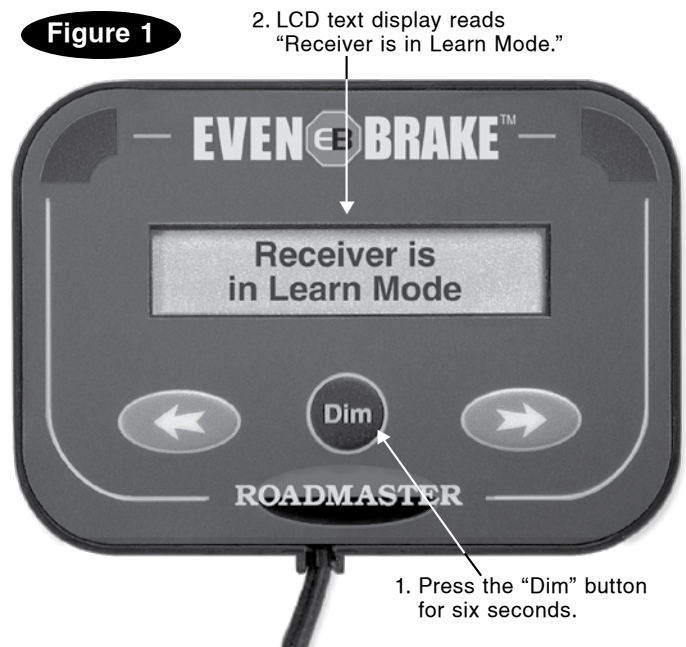

2. LCD text display reads "Receiver is in Learn Mode."

1. Press the "Dim" button for six seconds.

row (<) on the motorhome monitor to scroll to the appropriate message in this series – "Learning ICX #3..." or "Learning ICX #4..."

5. Press the green "Test" button (Figure 2) on the Even Brake touch pad control panel. Even Brake will begin a self-diagnostic test.

(As part of the test, Even Brake will cycle the brake pedal clamp up and down three times. When the brake

continued on next page

Figure 2

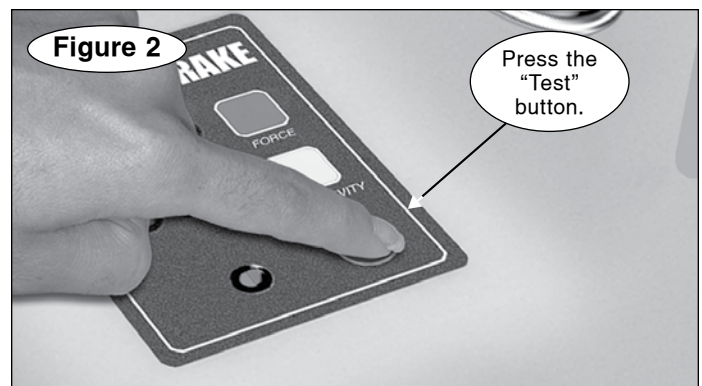

Press the "Test" button.

Program the monitor

continued from preceding page

pedal clamp is depressed, the LCD display at the motorhome monitor will read “Braking.”)

6. After Even Brake has completed the self-diagnostic test, the test light on the touch pad control panel will illuminate green to indicate the system is ready, or red to indicate the system is not ready.

- If the test light is green and the LCD display reads “Test Is Good – System Ready,” the motorhome monitor is programmed to the ICX transmitter. When the vehicle is towed, the monitor will display braking activity and system status information from Even Brake.

The monitor can be programmed in this manner for up to four vehicles. Once programmed, the monitor will automatically recognize the ICX transmitter in each vehicle without further adjustment.

- If the test light is red, check the motorhome monitor LCD text display for detailed information. You can also refer to the “Communications” sections (“Overview” and “Reference Chart”) in the Even Brake owner’s manual.

7. Before towing, read the Even Brake installation instructions and owner’s manual. Understand how to install and operate Even Brake, and carefully follow the instructions and safety precautions.



WARNING

Read all instructions before installing or operating Even Brake. Failure to understand how to install or operate Even Brake could result in property damage, personal injury or even death.

Check the ICX transmitter.

The Even Brake circuit board will be destroyed if the ICX transmitter is defective. To that end –

- If a new ICX transmitter is included, use it. Disconnect the old transmitter, connect the new one and reprogram the monitor, as described in the owner's manual. (The most current version of the manual is available at roadmasterinc.com.)
- If an ICX transmitter is not included, examine the socket on the existing transmitter. A plastic protector (Figure 1) must be in place. If it is not (Figure 2), **DO NOT USE THE TRANSMITTER!** Doing so will destroy the Even Brake circuit board.

Instead, call Roadmaster and order a replacement ICX transmitter.

- When you connect Even Brake to the ICX transmitter, the curved side of the plug (Figure 3) must align to the curved side of the socket (Figure 1) on the transmitter. If it does not, the Even Brake circuit board will be destroyed.

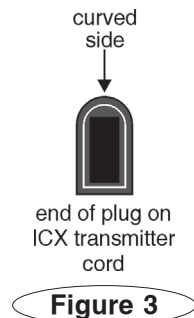
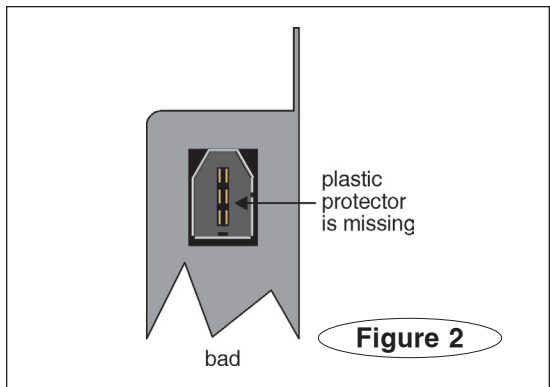
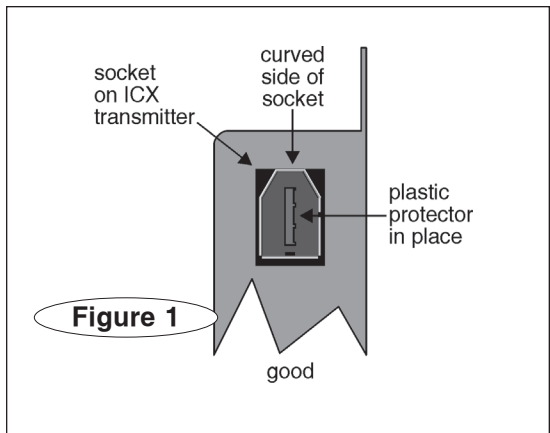

Time Tested • Time Proven

255294-00 09.14

Check the ICX transmitter.

The Even Brake circuit board will be destroyed if the ICX transmitter is defective. To that end –

- If a new ICX transmitter is included, use it. Disconnect the old transmitter, connect the new one and reprogram the monitor, as described in the owner's manual. (The most current version of the manual is available at roadmasterinc.com.)
- If an ICX transmitter is not included, examine the socket on the existing transmitter. A plastic protector (Figure 1) must be in place. If it is not (Figure 2), **DO NOT USE THE TRANSMITTER!** Doing so will destroy the Even Brake circuit board.

Instead, call Roadmaster and order a replacement ICX transmitter.

- When you connect Even Brake to the ICX transmitter, the curved side of the plug (Figure 3) must align to the curved side of the socket (Figure 1) on the transmitter. If it does not, the Even Brake circuit board will be destroyed.

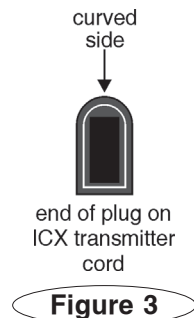
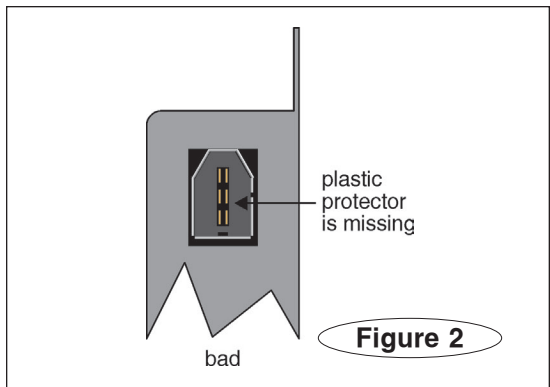
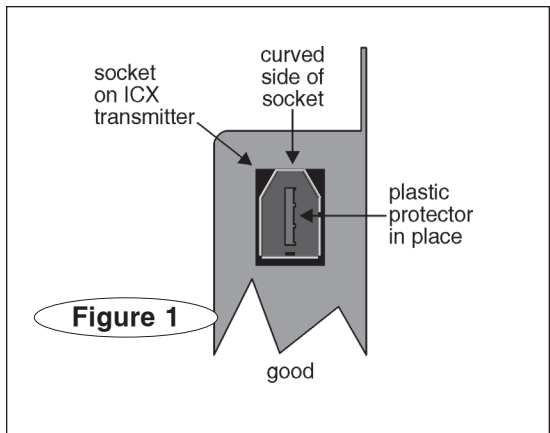

Time Tested • Time Proven

255294-00 09.14