



Spare tire carrier adaptor

part number 195225-95

Assembly instructions

855703-01 05-17

All specifications are subject to change without notice.

ROADMASTER, Inc. 6110 NE 127th Ave. Vancouver, WA 98682 800-669-9690 Fax: 360-735-9300 www.roadmasterinc.com

Fit chart

The adaptor will accommodate wheels with the following bolt circles:

	Minimum bolt circle	Maximum bolt circle
Even number of lugs (4, 6 or 8)	4½"	7"
Odd number of lugs (5 or 7)	4½"	6-1/8"

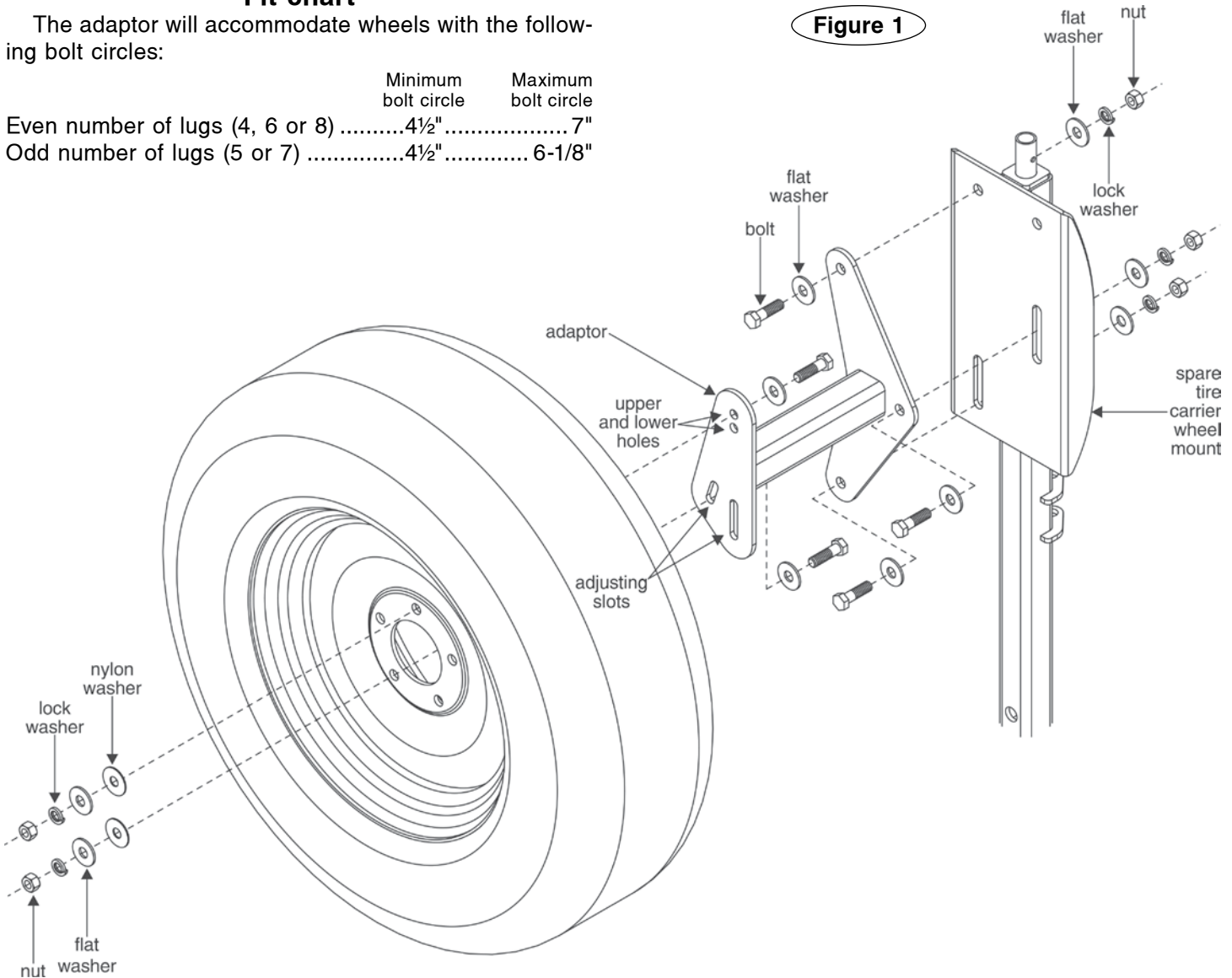

WARNING

Read all instructions before installing or using the adaptor. Failure to understand how to properly install or use the adaptor could result in property damage, personal injury or even death.



Required tools

- torque wrench
- ¾" socket wrench

Attach the adaptor

1. Use three sets of the included nuts, bolts, lock washers and flat washers to attach the adaptor to the spare

tire carrier, as shown in Figure 1.

Torque the three bolts to 57 ft./lbs.

Attach the spare tire

1. Follow the spare tire carrier instructions to lower the carrier, and roll the spare tire up to it. (The latest version of the instructions is at roadmasterinc.com, under 'Support.'

Position the wheel so that a lug hole is at the top, aligned to the upper and lower holes (Figure 1).

2. If the wheel has a smaller bolt circle (see the 'Fit Chart' above), insert a bolt and flat washer through the lower hole in the adaptor and through the spare; use the

continued on next page

continued from preceding page

upper hole for wheels with a larger bolt circle.

Swing the carrier up and allow it to lock. The lug hole directly opposite the bolt will line up in one of the two adjusting slots.

Attach the second bolt and flat washer through the wheel and the adjusting slot.

3. As shown in Figure 1, fasten the two sets of plastic washers, flat washers, lock washers and nuts on the other side of the wheel to the bolts and flat washers. Use the 3/4" socket wrench to tighten the two bolts.

CAUTION

Position the plastic washers directly against the wheel of the spare tire. Otherwise, non-warranty damage to the surface of the wheel may occur.

Parts

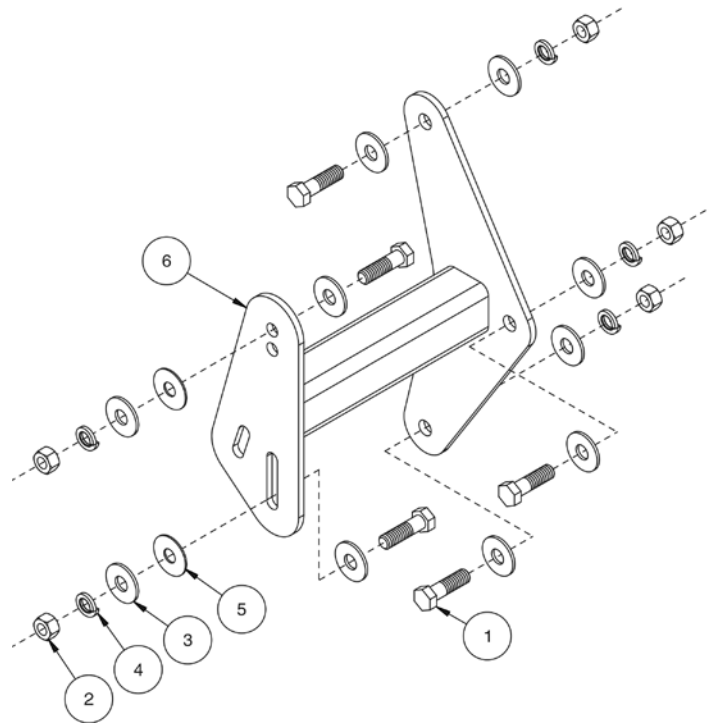

Item	Quan.	Description	Part Number
1	5	1/2-13 x 1 3/4" bolt.....	350096-00
2	5	1/2-13 hex nut.....	350258-00
3	10	1/2" flat washer	350308-00
4	5	1/2" lock washer	350309-00
5	2	9/16" x 2" x 0.063" nylon washer	350372-60
6	1	adaptor.....	C-003112

IMPORTANT NOTICE!

Safety Definitions

Statements in these instructions identified as follows are of special significance.

WARNING

WARNING indicates a potentially hazardous situation which, if not avoided, could result in property damage, serious personal injury or even death.

CAUTION

CAUTION indicates a potentially hazardous situation which, if not avoided, may result in property damage, or minor or moderate personal injury.

CAUTION

CAUTION used without the safety alert symbol indicates a potentially hazardous situation which, if not avoided, may result in property damage.

NOTE

Refers to important information and is placed in italic type. It is recommended that you take special notice of these items.